

01A

ADVANCED WARNING

ACCESS TO ROAD AHEAD CLOSED ON ____ TO ____ FOR ____ DAY(S)

FROM ____ TO ____

P7105

750mm

ROAD CLOSED

01

02

03

Diversion ENDS

04

Diverted traffic

05

Diverted traffic

06

Diverted traffic

07

Diversion

08

Diversion

09

Diversion

10

ROAD AHEAD CLOSED

11

Diverted traffic

12

Diverted traffic

13

Diverted traffic

14

Diverted traffic

15

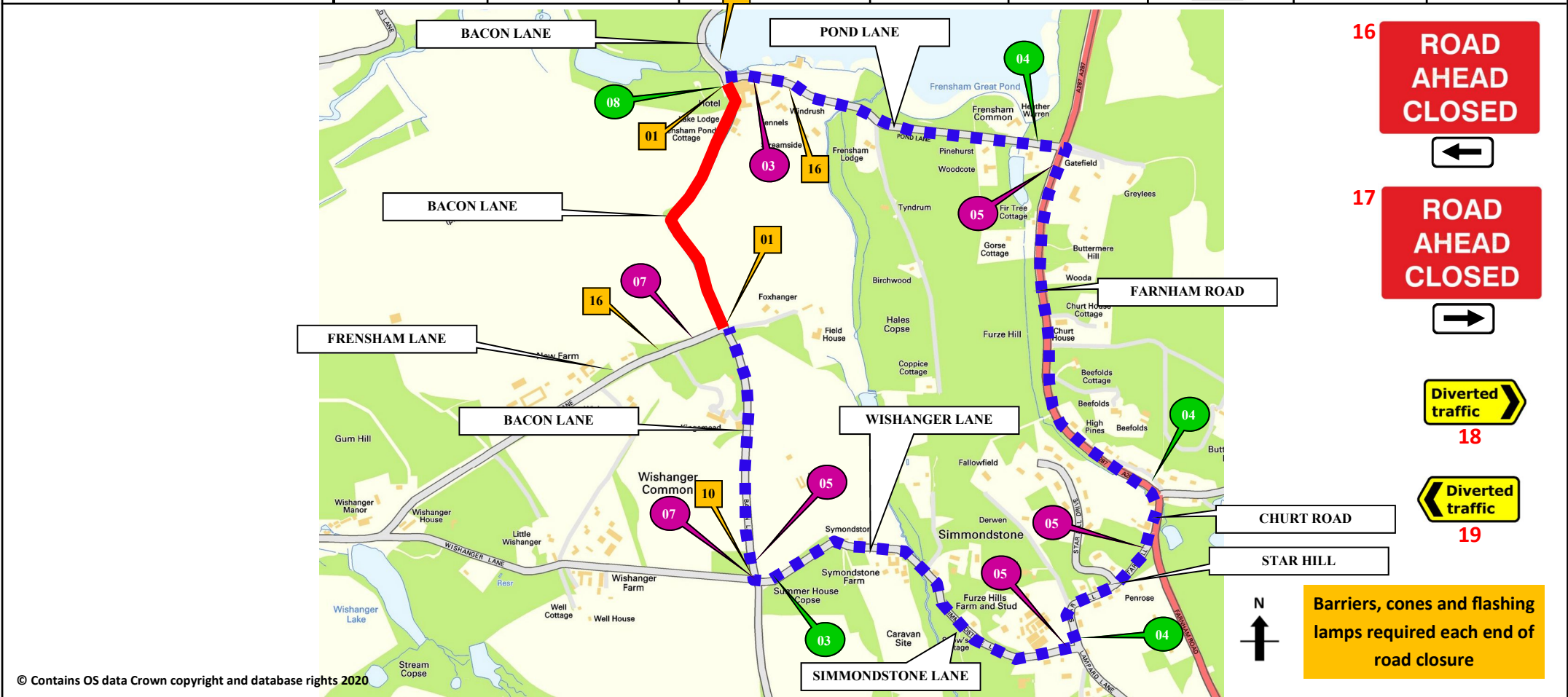

SUNBELT RENTALS

Sunbelt Rentals UK (Traffic Management)
Kemble Airfield Enterprise Park
Cirencester Road
Kemble
GL7 6BQ
☎ 03700 500 792
📠 0845 004 7105

Note

- All equipment shall be approved and shall comply with the Department Of Transport specification MCE0111. This drawing does not show the normal road works signage that will be required as per Chapter 8.
- All signs to be in accordance with TSGRD 2002 and to minimum class retroreflective.
- Minimum height of lettering to be 60mm and sign boards to be 1000mm (750mm where appropriate).

This drawing is protected by copyright and the information contained therein is confidential.

This drawing may not be copied and the information therein may not be used, or disclosed to a third party, wholly or in part with the written permission of Sunbelt Rentals UK (Traffic Management).

CROWN COPYRIGHT DATA REPRODUCED BY PERMISSION OF THE CONTROLLER OF HMSO

CLIENT DETAILS	REP/DEPOT	DRAWN BY	ADDRESS	
OPENREACH	133	SR	BACON LANE	
AMEND #	SHEET #	DATE	FARNHAM	
01 SR 21/08/2020	3 OF 6	15/06/2020	GU10 2QA	
TIME OF WORKS				
OFF PEAK	NIGHT	WEEKEND	WEEKDAY	24HR WORKS
0930-1530	2100-0600	SAT/SUN	MON-FRI	
✓				

BUS ROUTE AFFECTED

ROAD CLOSURE

DIVERSION

CLOCKWISE DIVERSION

ANTI-CLOCKWISE DIVERSION

ROAD CLOSURE SIGN

ROAD CLOSURE LENGTH (APPROX)

620M

ROAD CLOSURE WIDTH (APPROX)

3.4M

HIRE ADVICE

133-S011527