

Key

01A

01

02

03

04

05

06

07

08

09

10

11

12

13

14

15

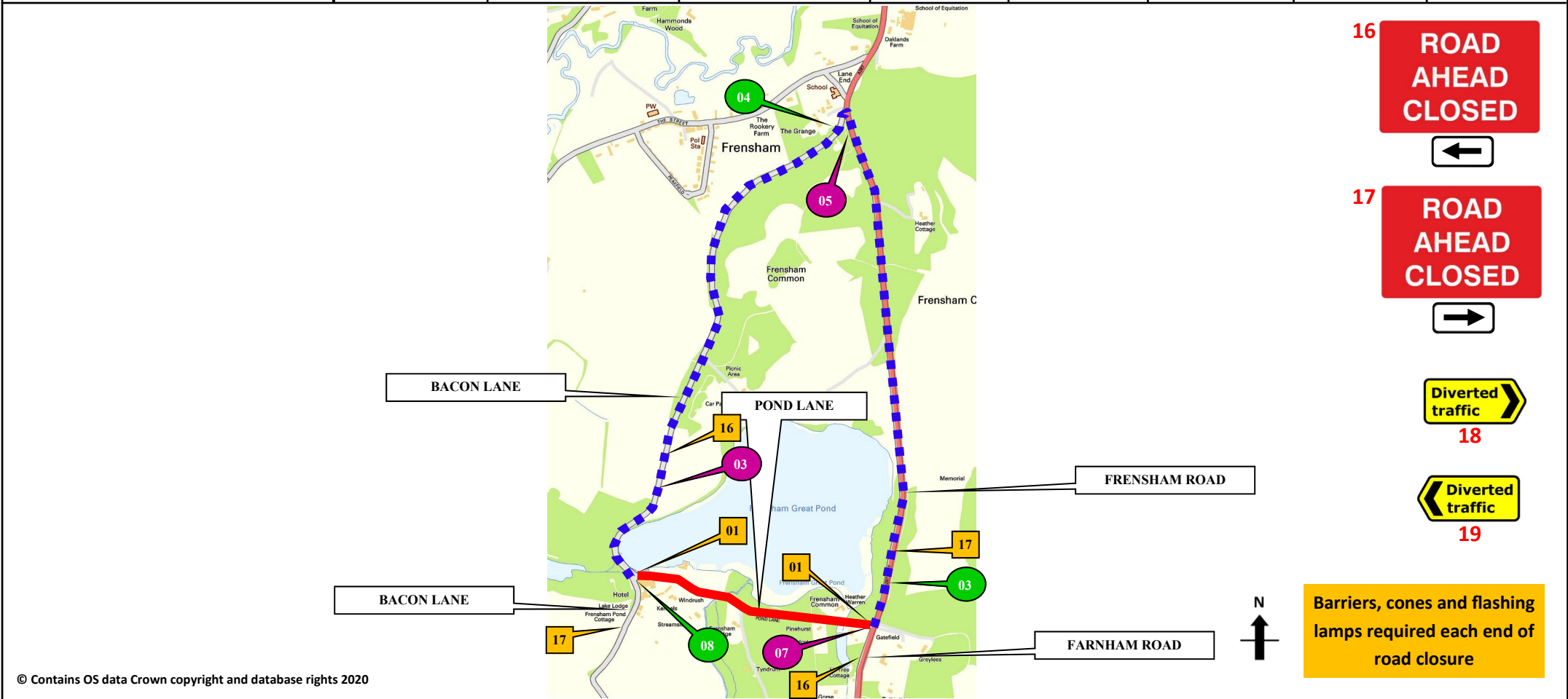

Sunbelt Rentals UK (Traffic Management)
Kemble Airfield Enterprise Park
Cirencester Road
Kemble
GL7 6BQ
☎ 03700 500 792
📠 0845 004 7105

Note

- All equipment shall be approved and shall comply with the Department Of Transport specification MCE0111. This drawing does not show the normal road works signage that will be required as per Chapter 8.
- All signs to be in accordance with TSGRD 2002 and to minimum class retroreflective.
- Minimum height of lettering to be 60mm and sign boards to be 1000mm (750mm where appropriate).

This drawing is protected by copyright and the information contained therein is confidential.

This drawing may not be copied and the information therein may not be used, or disclosed to a third party, wholly or in part with the written permission of Sunbelt Rentals UK (Traffic Management).

CROWN COPYRIGHT DATA REPRODUCED BY PERMISSION OF THE CONTROLLER OF HMSO

CLIENT DETAILS OPENREACH	REP/DEPOT 133	DRAWN BY SR	ADDRESS POND LANE FARNHAM GU10 2QA
AMEND # 01 SR 21/08/2020	SHEET # 1 OF 6	DATE 15/06/2020	
TIME OF WORKS			
OFF PEAK 0930-1530	NIGHT 2100-0600	WEEKEND SAT/SUN	WEEKDAY MON-FRI
<input checked="" type="checkbox"/>			

ROAD CLOSURE
 DIVERSION

CLOCKWISE DIVERSION
 ANTI-CLOCKWISE DIVERSION
 ROAD CLOSURE SIGN

ROAD CLOSURE LENGTH (APPROX) 770M

ROAD CLOSURE WIDTH (APPROX) 3.4M

HIRE ADVICE **133-S011527**